



## EXECUTIVE MEETING CENTER

At DoubleTree by Hilton™ Omaha Downtown, the **Executive Meeting Center** is the only dedicated environment in the state of Nebraska extending attentive service, complex technology, a diverse dining experience, and complete packaging. We stand in marked contrast to traditional hotel settings. Our environment promotes productivity and helps you reach your personal and business goals. Our center provides you better tools to motivate, communicate, interact and produce more effectively than ever.

### DEDICATED ENVIRONMENT

- Tackable Wall Surfaces
- Whiteboard Surfaces
- Ergonomic Chairs Rated for 18 Hours of Comfort
- Non-Glare, Hard Writing Surfaces
- Unobstructed Interior Views
- Individual Climate Control
- 24-Hour Meeting Room Access
- Telephone Rooms for Impromptu Conference Calls
- Conference Supplies
- Meeting Toolkit

Our environment is dedicated for the sole purpose of conducting productive meetings. Meeting rooms are designed to reduce fatigue and increase productivity. Rooms vary in size to suit differing configurations, seating requirements and group size. We've created an environment where learning, communication and interaction flourish - where productivity becomes a reward in itself.

### COMPLEX TECHNOLOGY

- Wireless High-Speed Internet Access in all Meeting Rooms
- Teleconferencing Capabilities
- Access to a Complete Line of Audio/Visual Equipment and Computers
- Centralized Business Center with Support Services

Technology is an important component of a successful meeting. The Executive Meeting Center gives you a powerful combination of high-tech, high-touch technology, allowing conferees high-speed access to the information they need immediately. In addition, we provide technical support for presenting sophisticated audio/visual presentations and customized solutions to meet the most complex requirements. Our Business Center, located in the heart of our operations, is staffed with courteous, eager-to-please professionals who are ready to assist you with any support you may require.



### BASIC MEETING PACKAGE COMPONENTS

- Upgraded Continental Breakfast and Afternoon Break
- Continuously Replenished Beverage Service
- Lunch Buffet
- 24-Hour Dedicated Meeting Rooms
- Audio/Visual Equipment, including an LCD Projector, Flipcharts & Whiteboards
- Dedicated Conference Planning Manager
- Wireless High-Speed Internet Access
- Self Parking
- No Handling Fees for Shipping and Receiving
- Business Center Services (photocopying, faxing, computer usage, etc)
- Name Badges & Tent Cards
- No Gratuities or Service Charges
- Private Banquet Service Options

### EASY TO BOOK AND EASY TO BUDGET

Our meeting package offers the optimal convenience of all-inclusive pricing. We have included all the key elements of a successful meeting into a convenient per person, per-day package. It's easy, and we guarantee you will never want to hold a meeting anywhere else ever again.

- See All Costs Up Front With No Guesswork
- Greater Value for Your Dollar
- Save Time Planning Your Meeting
- Packages Can be Customized to Suit Your Needs

### GUEST ROOMS

Our guest rooms create the perfect atmosphere to add to the successful meeting experience. Each room provides the necessities of both home and office. Guest rooms are equipped with two phones, high-speed wireless internet access, large working desk, complimentary morning USA Today, in-room coffee maker, hairdryer, 42" flat-screen televisions with HD channels, and clock radio.

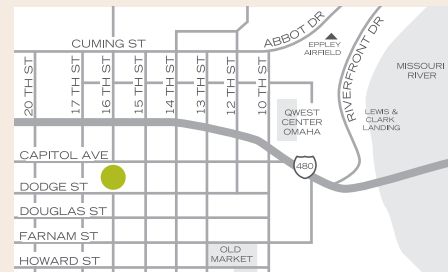

### LOCATION

In the heart of downtown's business and entertainment district, DoubleTree by Hilton Omaha Downtown puts you only a 10 minute ride on our complimentary shuttle from Eppley Airfield.



## EXECUTIVE MEETING CENTER

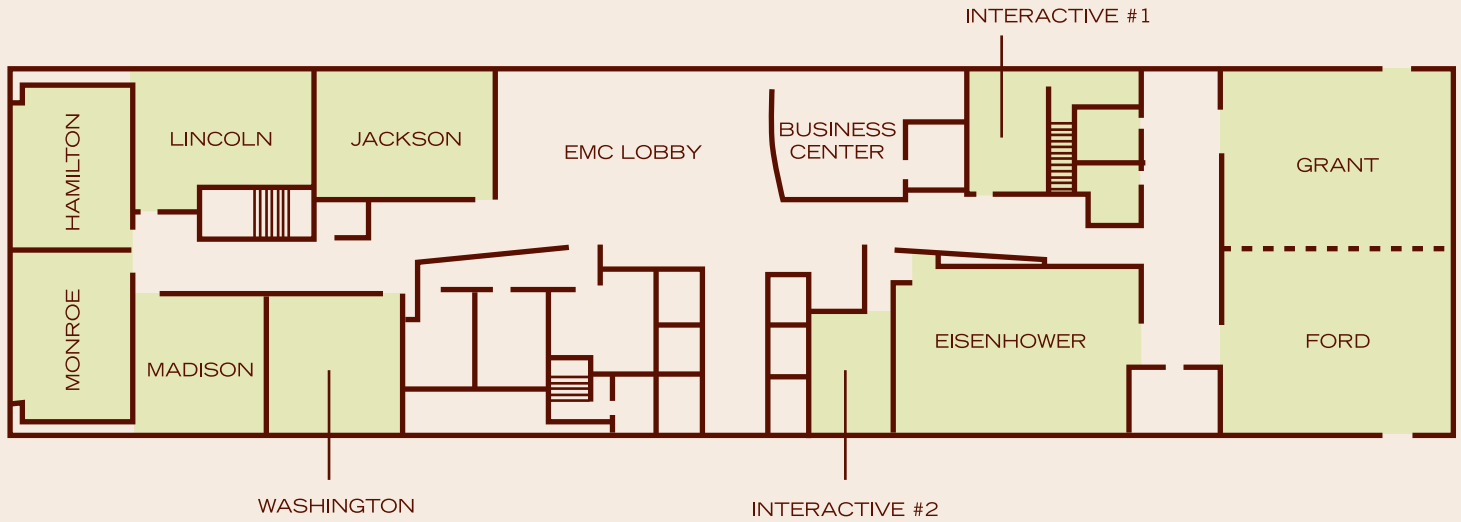

Name of Room	Total Sq. Ft.	U-Shape	H-Square	Conference	Classroom	Pods
Washington	538	14	20	12	12	18
Madison	539	14	20	12	14	18
Monroe	583	14	20	16	18	18
Hamilton	565	16	22	16	18	18
Lincoln	654	20	26	18	24	18
Jackson	664	16	20	16	24	18
Eisenhower	1,123	26	32	24	36	36
Grant/Ford	2,340	42	64	40	76	70
Grant	1,170	22	32	20	40	36
Ford	1,170	22	32	20	40	36
Interactive 1	285	-	-	12	-	-
Interactive 2	273	-	-	12	-	-