

## MAKE YOUR NEXT MEETING SIMPLY SUCCESSFUL

### AT A GLANCE:

- 154 two-room hotel suites with accessible rooms
- Over 5,000 sq.ft. of meeting space that accommodates 150 guests
- Audio/Visual equipment rental available
- Breakfast, lunch, and dinner options
- Complimentary lobby-level WiFi
- Business Center with complimentary printing service
- Restaurant & Bar on-site

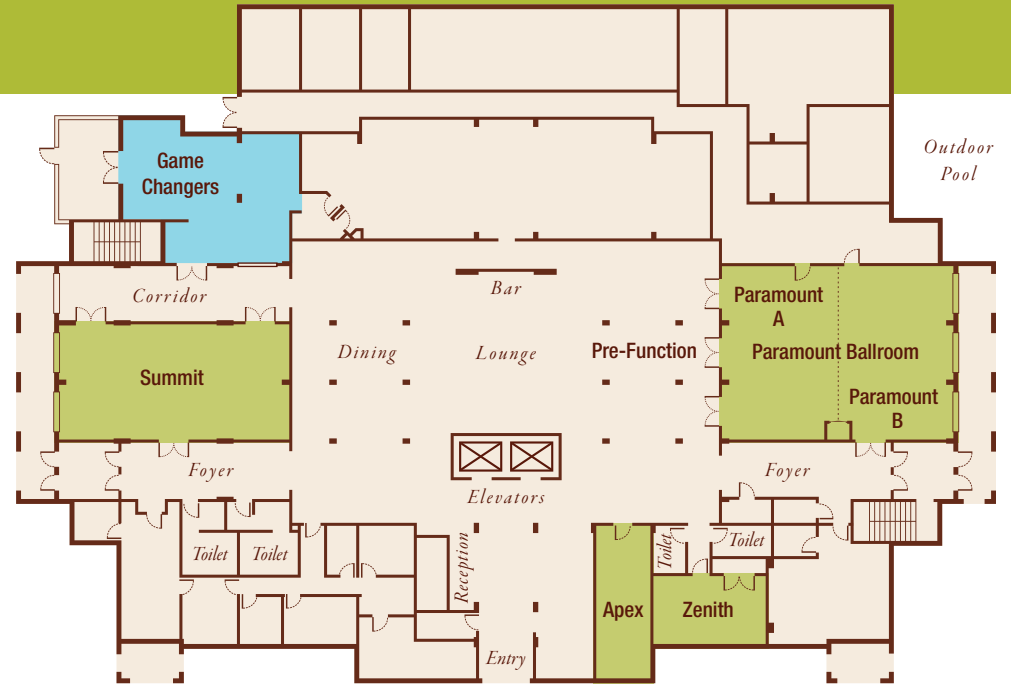

### CAPACITY BY LAYOUT:

Meeting Rooms	Total Sq.Ft.	Room Size	Ceiling Height	MAXIMUM NUMBER OF PEOPLE PER SEATING STYLE						
				Classroom	Theater	Banquet 10	Reception	Conference	U-Shape	H-square
Apex	384	32.00' x 12.00'	10'	N/A	N/A	N/A	N/A	12	N/A	N/A
Paramount A	828	36.00' x 23.00'	10'	40	70	48	75	30	25	30
Paramount Ballroom	1,656	36.00' x 46.00'	10'	80	150	115	175	45	40	45
Paramount B	864	36.00' x 24.00'	10'	40	70	48	75	30	25	30
Pre-Function	1,128	47.00' x 24.00'	90'	N/A	N/A	N/A	150	N/A	N/A	N/A
Summit	1,128	47.00' x 24.00'	10'	60	75	64	75	40	35	40
Zenith	391	23.00' x 17.00'	10'	20	30	25	25	20	16	20

### DOUBLETREE SUITES BY HILTON ATLANTA - GALLERIA

• 2780 Windy Ridge Parkway, Atlanta, Georgia 30339 USA • Tel: +1-770-980-1900 • Fax: +1-770-980-0611