

MAIN FLOOR

Name of Room	Total Sq. Ft.	Dimensions	Ceiling Ht.	Classroom	Theatre	Banquet	Reception	Conference	U-Shape
California Ballroom	2,960	73.83' x 39.75'	12'	120	350	180	300	60	65
Malibu & Sunset	1,974	49.25' x 39.75'	12'	100	200	120	180	40	50
Sunset & Redondo	1,974	49.25' x 39.75'	12'	100	200	120	180	40	50
Malibu	987	24.58' x 39.75'	12'	45	100	50	90	34	30
Redondo	987	24.58' x 39.75'	12'	45	100	50	90	34	30
Sunset	987	24.58' x 39.75'	12'	45	100	50	90	34	30
Grand Ballroom	8,085	66' x 122.5'	16'	450	1,000	550	1,000	100	120
Hermosa, Huntington & Manhattan	4,620	66' x 70'	16'	260	500	300	200	76	74
Hermosa, Huntington, Manhattan & Corridor	5,775	66' x 87.5'	16'	300	560	350	500	76	92
Huntington & Manhattan	2,310	66' x 35'	16'	100	200	150	180	52	62
Huntington Manhattan & Corridor	3,465	66' x 52.5'	16'	160	400	200	250	52	65
Huntington, Manhattan, Corridor, Laguna & Newport	5,775	66' x 87.5'	16'	320	800	400	500	90	120
Corridor, Laguna & Newport	3,465	66' x 52.5'	16'	160	400	200	300	52	65
Laguna & Newport	2,310	66' x 35'	16'	100	200	150	200	50	60
Hermosa	2,310	66' x 35'	16'	100	200	150	200	50	60
Huntington	1,216	35' x 35'	16'	45	100	60	90	30	34
Manhattan	1,094	31' x 35'	16'	45	100	60	90	30	34
Corridor	1,155	66' x 17.5'	16'	-	-	-	-	-	-
Laguna	1,216	35' x 35'	16'	45	100	60	90	30	34
Newport	1,094	31' x 35'	16'	45	100	60	90	30	34
International Center Patio	2,735	-	-	-	-	-	-	-	-
IC Boardroom	524	-	12'	-	-	-	-	10	-
Atrium	2,460	29.75' x 75.33'	33'	130	180	120	200	52	60
International Center	1,460	25' x 52'	12'	40	75	70	100	34	25
Lobby Bar	1,080	32.5' x 50'	12'	-	-	-	-	-	-
Patio	-	88' x 55.5'	-	-	-	-	-	-	-

SECOND FLOOR

Name of Room	Total Sq. Ft.	Dimensions	Ceiling Ht.	Classroom	Theatre	Banquet	Reception	Conference	U-Shape
Lassen	1,036	27.83' x 39.25'	9'	50	100	60	75	30	30
Redwood	624	26.25' x 24.58'	9'	30	45	40	60	20	25
Sequoia	624	25.33' x 24.5'	9'	30	45	40	60	20	25
Shasta	492	18' x 24.5'	9'	18	25	20	30	16	20
Sierra	312	13.5' x 24.5'	9'	-	-	-	-	8	-
Tahoe	576	19.17' x 24.58'	9'	18	25	20	30	15	20
Yosemite	676	25.67' x 27.00'	9'	35	45	40	50	22	27

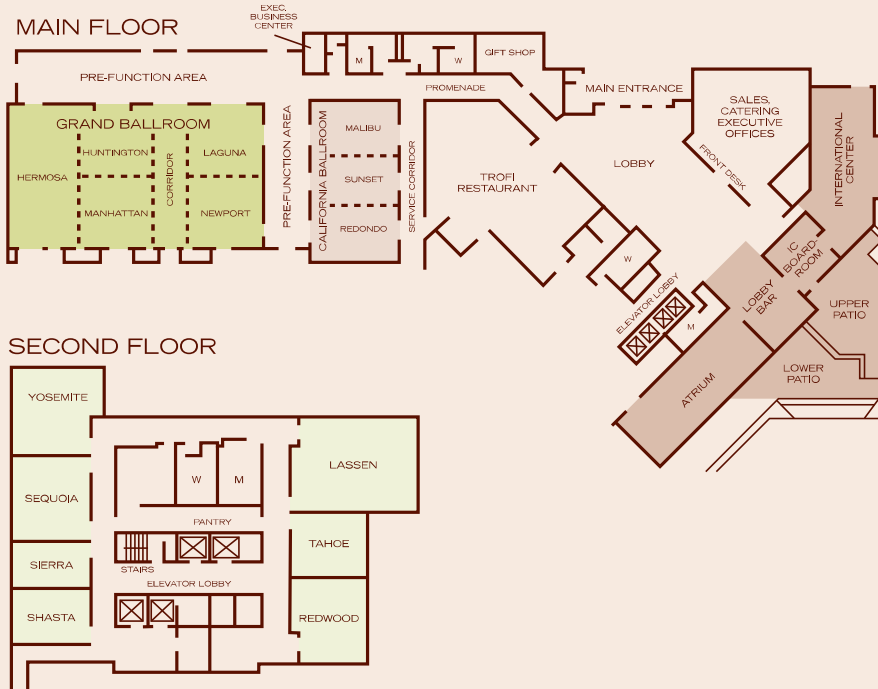

DOUBLETREE BY HILTON ANAHEIM – ORANGE COUNTY

100 The City Drive Orange, CA 92868 (714) 634 4500

SNACC\_DT\_Hotel@hilton.com | AnaheimOrangeCounty.DoubleTree.com

GDS CODES

Amadeus: ANADCD  
 Apollo/Galileo: 19011  
 Sabre: 7949  
 Worldspan: ORADC